

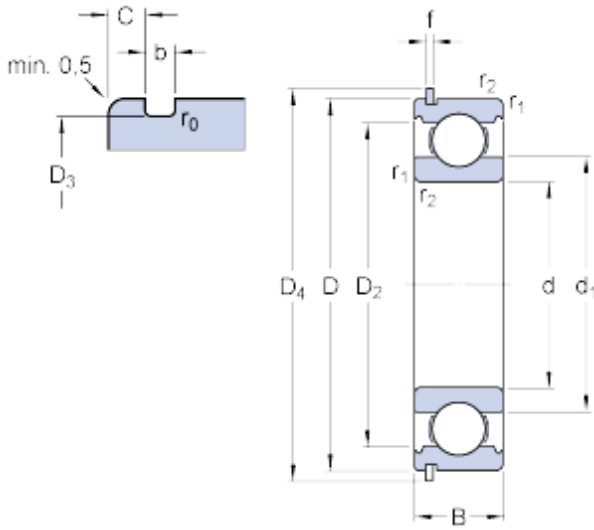

Bearing company



30 mm x 62 mm x 16 mm skf 6206 nr bearing

Bearing No. 6206 nr

Size	62x30x16 mm
Bore Diameter	62 mm
Outer Diameter	30 mm
Width	16 mm
d	30 mm
D	62 mm
B	16 mm
d ₁	40.36 mm
D ₂	54.06 mm
D ₃	59.61 mm
D ₄	67.7 mm
b	1.9 mm
C	3.28 mm
f	1.7 mm
r ₀	0.6 mm
r _{1,2} - min.	1 mm
d _a - min.	35.6 mm
D _a - max.	56.4 mm
D _b - min.	69 mm
b _a - min.	2.2 mm
C _a - max.	4.98 mm
r _a - max.	1 mm
Basic dynamic load rating - C	20.3 kN
Basic static load rating - C ₀	11.2 kN
Fatigue load limit - P _u	0.475 kN

6206 nr Bearing 2D drawings and 3D CAD models



Bearing company

Reference speed	24000 r/min
Limiting speed	15000 r/min
Calculation factor - k_r	0.025
Calculation factor - f_0	13.8
Mass bearing	0.205 kg
Category	Single Row Ball Bearings
Inventory	0.0
Manufacturer Name	SKF
Minimum Buy Quantity	N/A
Weight / Kilogram	0.21
EAN	7316577741073
Product Group	B00308
Enclosure	Open
Precision Class	ABEC 1 ISO P0
Maximum Capacity / Filling Slot	No
Rolling Element	Ball Bearing
Snap Ring	Yes
Internal Special Features	No
Cage Material	Steel
Internal Clearance	C0-Medium
Inch - Metric	Metric
Long Description	30MM Bore; 62MM Outside Diameter; 16MM Outer Race Width; Open; Ball Bearing; ABEC 1 ISO P0; No Filling Slot; Yes Snap Ring; No Internal Special Features; C0-Medium Internal Clearance; Steel Cage
Other Features	Deep Groove With Snap Ring
Category	Single Row Ball Bearing
UNSPSC	31171504



Bearing company

Harmonized Tariff Code	8482.10.50.68
Noun	Bearing
Keyword String	Ball
Manufacturer URL	http://www.skf.com
Manufacturer Item Number	6206 NR
Weight / LBS	0.439
Outer Race Width	0.63 Inch 16 Millimeter
Inner Race Width	0 Inch 0 Millimeter
Outside Diameter	2.441 Inch 62 Millimeter
Bore	1.181 Inch 30 Millimeter
d_1	40.36 mm
D_2	54.06 mm
D_3	59.61 mm
D_4	67.7 mm
r_0 max.	0.6 mm
$r_{1,2}$ min.	1 mm
d_a min.	35.6 mm
D_a max.	56.4 mm
D_b min.	69 mm
b_a min.	2.2 mm
C_a max.	4.98 mm
r_a max.	1 mm
Basic dynamic load rating C	20.3 kN
Basic static load rating C_0	11.2 kN
Fatigue load limit P_u	0.475 kN
Calculation factor k_r	0.025
Calculation factor f_0	13.8
Snap ring	SP 62